

# Microsoft's New Edge for Windows 10 – Session 4



APCUG Workshop

*Getting to Know Windows from An Insiders Point of View*

**Bill James**  
**APCUG Advisor,**  
**Region 8**  
**Member, APCUG**  
**Speakers Bureau**

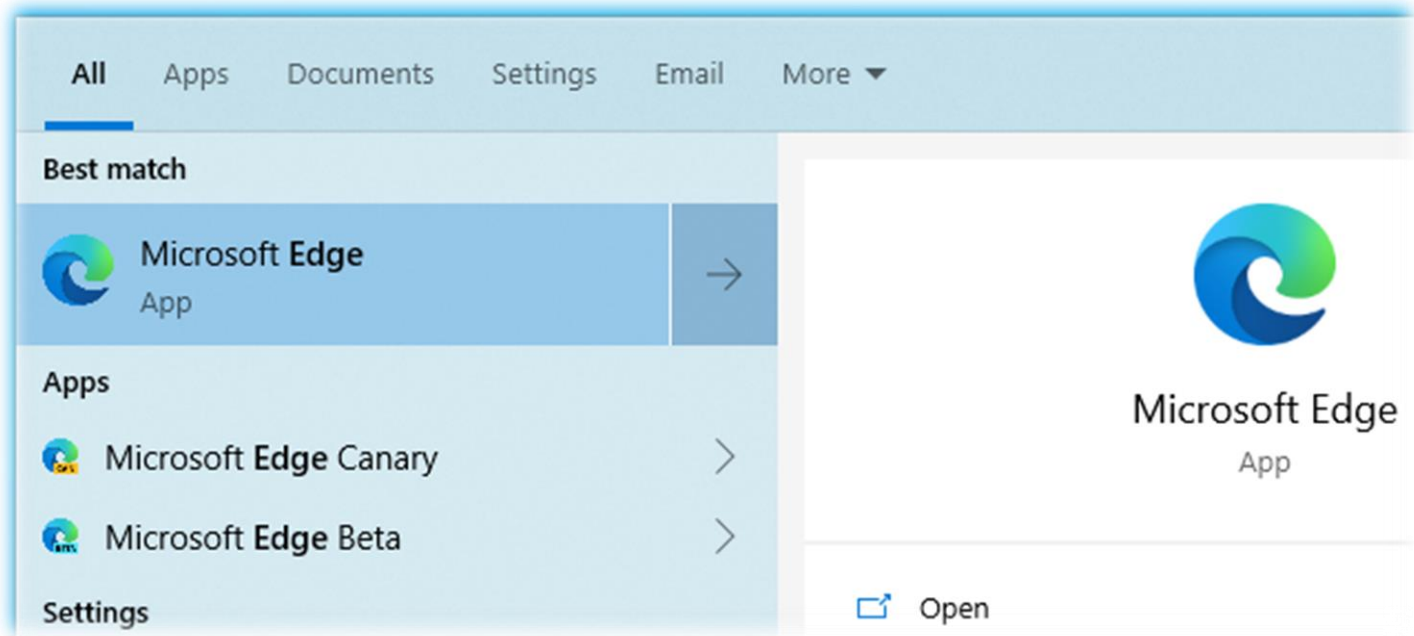



# The New Microsoft Edge

The new Microsoft Edge is built on top of Chromium. It is truly cross-platform and available for Windows 7, 8, 10, macOS, Android, and iOS with a Linux version in the works.

# Microsoft Edge

## Browsers in General

An internet browser, also known as a web browser or simply a browser, is a software program that you use to view web pages on your computer. You can think of your browser as your gateway to the internet

If you want to enter online sweepstakes, for example, you must first open the giveaways' websites in your internet browser.

The main purpose of an internet browser is to translate the code that computers use to create websites into the text, graphics, and other features of the web pages that we are all used to seeing today.

The first web browser was called World Wide Web and later changed its name to Nexus.

Created by Sir Tim Berners-Lee, it was released in 1990 and gave people a basic way to view web pages. But it was a long way from the immersive online experience we have today.

Without browsers, the internet as we know it today would not be possible.

Before the first popular graphical browser 'Mosaic' was released in 1992, the internet was text-based, bland, and couldn't be used without technical know-how.

This limited the number of people who had the ability and the interest to use the internet.

Internet browsers have developed into powerful tools that let you safely and quickly access your favorite websites.

# Microsoft Edge

This is very helpful if  
you want to enter  
sweepstakes faster.

# Microsoft Edge

## **A Browser is not a Search Engine**

- Believe it or not, many people don't know the difference between a web browser and a search engine.
- If you do know the difference, congratulations, but for the others who don't, here are a few pointers to easily differentiate between these two usually interchangeable words.
- By simply taking in the keywords of each word, in this case the words browser and search, you can immediately identify one major difference between the two.
- One is programmed to browse a webpage, and one is to search for a webpage.
- One other notable difference is that while a web browser can exist without a search engine, a search engine needs a web browser to display its results.
- This simply means that a web browser is the basic element in accessing the Internet, whereas a search engine is to simply search for keywords in a search engine's database.
- In other words, you can't access any data without a web browser, but you can go to a certain website without the use of a search engine.

# Microsoft Edge

## Do I have to use Microsoft Edge in Windows 10?

- You can't remove Edge, but you do not need to use it.
- You can delete the icon from the taskbar and the start menu if you like, but you can't un-install it.
- Microsoft has been struggling to get people to use its Edge browser for years.
- Even though the company made Edge the default browser in Windows 10, users left in droves, most of them flocking to Google Chrome — and with good reason.
- Edge was underpowered, had difficult-to-use features, and offered very few extensions compared to Chrome and Firefox.
- Now Microsoft has launched a new version of Edge that's based on the same technologies that drive Chrome.
- The new Edge is a much better browser, and there are compelling reasons to use it.
- But you might still prefer to use Chrome, Firefox, or one of the many other browsers.

# Microsoft Edge

## Microsoft Edge

- By default, installed on all Windows-based devices.
- Improved, faster execution than Internet Explorer.
- More stable both as a Windows application and when displaying web apps.
- Supports more casting devices through the Digital Living Network Alliance (DLNA) and Miracast protocols.
- Can run extensions from the Microsoft Store and Chrome Web Store.
- Built-in tracking prevention and potentially unwanted program blocker.

V.S.

## Google Chrome

- Open source.
- Has a large extension library.
- The most widely supported browser available, especially for consumer devices.
- Cross-platform availability.
- A bit of a memory hog.
- Future of ad blockers uncertain as Google starts to inhibit them.
- Separate download and installation on all operating systems but Android.

# Microsoft Edge



Google is annoyed that people are using Edge 

- When users log in to their Gmail accounts from a new device -- via the strange browser that is the new Edge -- they get the standard security alert email message:
- *"Make the most out of Windows 10 with the Chrome browser. Chrome is a fast, simple, and secure browser, built for the modern Web."*
- Microsoft's Edge browser is getting increasingly popular as a valid alternative to Google Chrome.



# Microsoft Edge

## How is the new Edge different from the old Edge?

- The new Microsoft Edge  is based on Chromium and was released January 15, 2020. It's compatible with all supported versions of Windows, and with macOS.
- When you download this browser, it replaces the legacy version of Microsoft Edge on Windows 10 PCs.
- With speed, performance, best-in-class compatibility for websites and extensions, and built-in privacy and security features, it's the only browser you'll ever need.
- Microsoft Edge Legacy  is the HTML-based browser launched with Windows 10 in July 2015.
- It is the default browser on Windows 10 PCs.

# Microsoft Edge

## Key Features of the New Edge

- o InPrivate Mode
- o Save webpage as PDF
- o Tab browsing
- o Crapware Blocker
- o Immersive Reader
- o Automatic Profile Switching
- o Browser Extensions (Microsoft / Chrome)

# Microsoft Edge

## Key Updates to the New Microsoft Edge

Some of these new features include a built-in QR code generator, Collections, and tight integration into Windows 10 and networking domains.

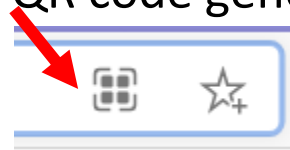

### Extensions Sync

As Microsoft Edge is built on the Chromium browser, you can install not only browser extensions designed for Edge, but also those that are created for Chrome.

### Collections Features

- Microsoft Edge has a unique feature called Collections that allows users to collect and compare shopping items, collect and combine information from platforms like Wikipedia, and put together event or research information in a dedicated panel for later reference.
- In the next release, Microsoft is improving the Collections feature by allowing users to save all their open tabs into a new or existing collection.
- You could then reopen all the tabs from another device that you are logged into.

# Microsoft Edge

## Key Updates to the New Microsoft Edge

### Automatic Profile Switching

- As a huge number of people are working from home during the COVID-19 crisis, Microsoft is about to add some more new features to Edge to make it more secure for those staying away from the office.
- The first change is an update to Microsoft Edge's "Profiles" feature to make it easier for you to separate work and personal browsing.
- Automatic Profile Switching helps keep work and personal data separate.
- People who use multiple profiles can check it out by navigating to a site authenticated with a work account while in their personal profile.
- To help stop you getting mixed up, Microsoft will detect this is happening and prompt you to switch to your work profile to access the site without you having to authenticate to it.

# Microsoft Edge

## Key Updates to the New Microsoft Edge

### Avoiding Malicious Sites and Downloads

- SmartScreen Filter is a feature in Microsoft Edge that helps detect phishing websites.
- It can also help protect you from downloading or installing malware (malicious software).
- As you browse the web, it analyzes webpages and determines if they have any characteristics that might be suspicious.
  - If it finds suspicious webpages, SmartScreen will display a message giving you an opportunity to provide feedback and advising you to proceed with caution.
- SmartScreen Filter checks the sites you visit against a dynamic list of reported phishing sites and malicious software sites.
  - If it finds a match, SmartScreen Filter will show you a warning notifying you that the site has been blocked for your safety.

# Microsoft Edge

## Key Updates to the New Microsoft Edge

### SmartScreen Filter

#### App & browser control

App protection and online security.

#### Check apps and files

Windows Defender SmartScreen helps protect your device by checking for unrecognized apps and files from the web.

- Block
- Warn
- Off

#### SmartScreen for Microsoft Edge

Windows Defender SmartScreen Filter helps protect your device from malicious sites and downloads.

On

# Microsoft Edge

## Key Updates to the New Microsoft Edge

### Avoiding Malicious Sites and Downloads

- SmartScreen Filter checks files you download from the web against a list of reported malicious software sites and programs known to be unsafe.
  - If it finds a match, SmartScreen Filter will warn you the download has been blocked for your safety.
  - SmartScreen Filter also checks the files you download against a list of files that are well known and downloaded by many Microsoft Edge users.
  - If the file you're downloading isn't on that list, SmartScreen Filter will warn you.
- In addition to blocking an unsafe site, SmartScreen will also navigate away from and unload the page
  - This will completely block any audio and replace the site's contents with the prominent, red SmartScreen safety message.

# Microsoft Edge

## Other improvements



### QR code generator

- The QR code generator allows sharing links from a PC to a mobile device much easier
- It creates a QR code for a specific page that you can then scan with your mobile phone's camera to quickly navigate to the same address.
- Clicking this icon instantly generates a QR code for the page you're on, and you can either scan the code with a mobile phone or download it and then share it using a different method.
- Additionally, the QR code generator can also be launched by right-clicking on the page you want to share.
- Microsoft has added a dedicated option to run the QR code generator from the Edge context menu, and regardless of the method you choose, they both do pretty much the same thing.



# Microsoft Edge

## Other improvements

### Enable QR code generator in Edge

- To enable the QR code generator in Edge Chromium
- Open Edge Browser type the below flags path in the address bar.
- Once enabled, Edge will display a “QR code” icon in the address bar and you can click on it to generate the code.

#### Enable sharing page via QR Code

Enables right-click UI to share the page's URL via a generated QR Code. – Mac, Windows

[#sharing-qr-code-generator](#)

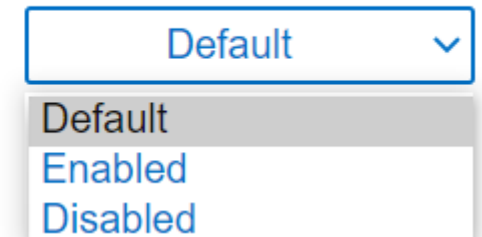

# Microsoft Edge

## Other improvements

### Immersive Reader

- Note: Immersive Reader works only on websites that support the feature.
- To switch to Immersive Reader in Microsoft Edge:
  - Select the Immersive Reader icon, which looks like a book with a speaker on it, on the right side of the address bar.
  - Or, use the keyboard shortcut Ctrl+Shift+R.
- The icon turns blue, and the page is reformatted to improve its readability and removes navigation elements – no ads.

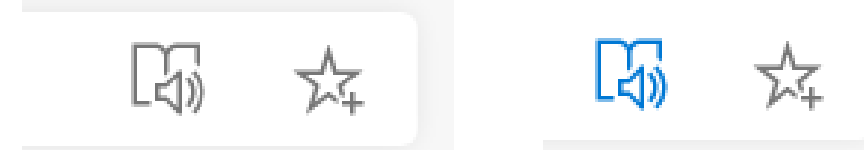

# Microsoft Edge

## Other improvements

### Immersive Reader

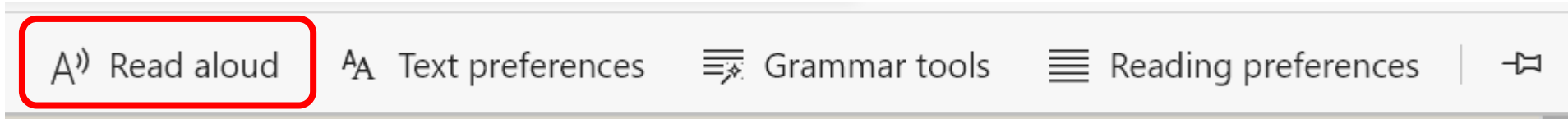

- Hover at the top of the page to drop down the above bar.
- Choose a voice and speed. You can also add more voices.
- Right-click on the page where you want to start Immersive Reader reading the text.

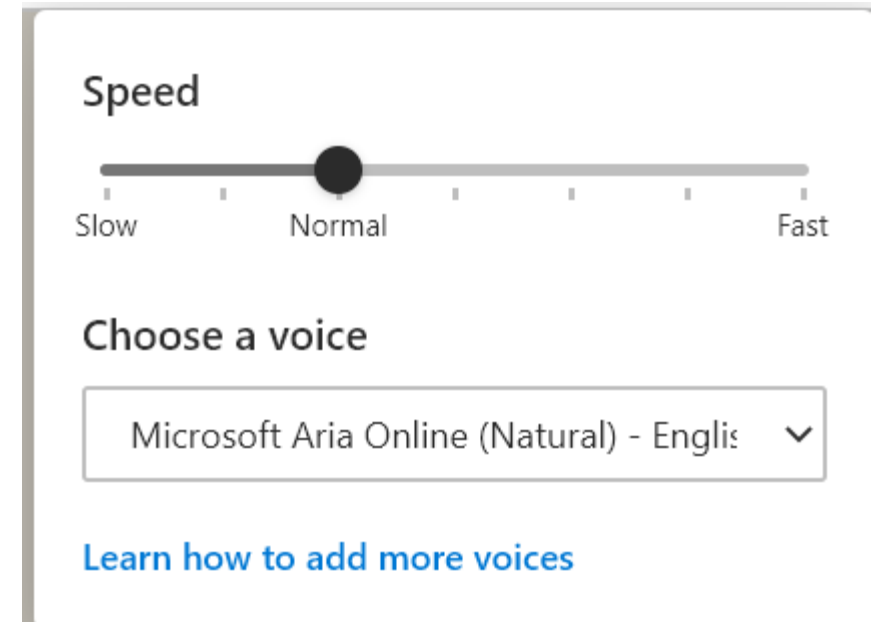

# Microsoft Edge

## Other improvements

### Immersive Reader

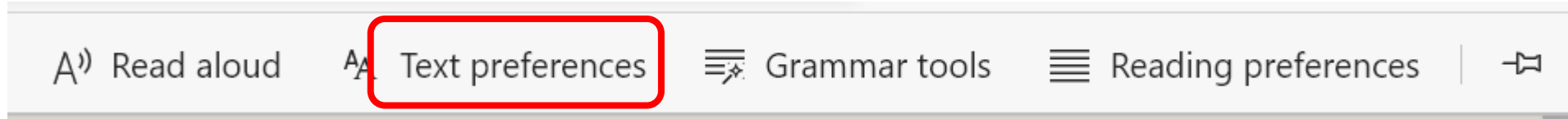

- Move the Text size slider to increase or decrease the font size.
- You can also adjust the text spacing.
- Under Page themes, select a background color for easier reading.

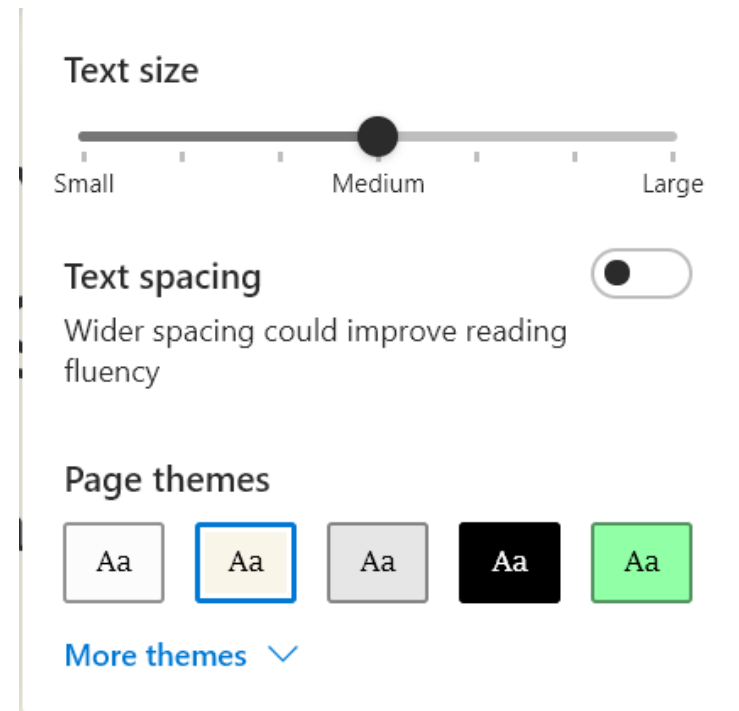

# Microsoft Edge

## Other improvements

### Immersive Reader

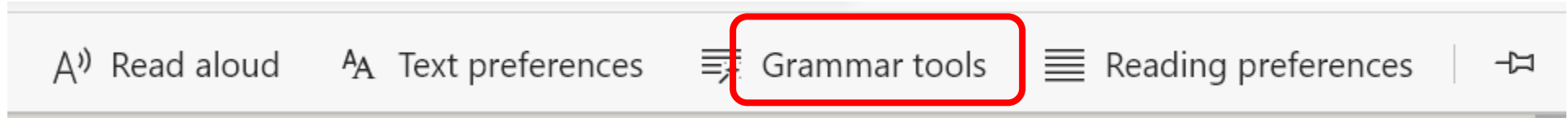

- Turn on Syllables to split words into syllables.
- You can also color-code the nouns, verbs, and adjectives on the page.

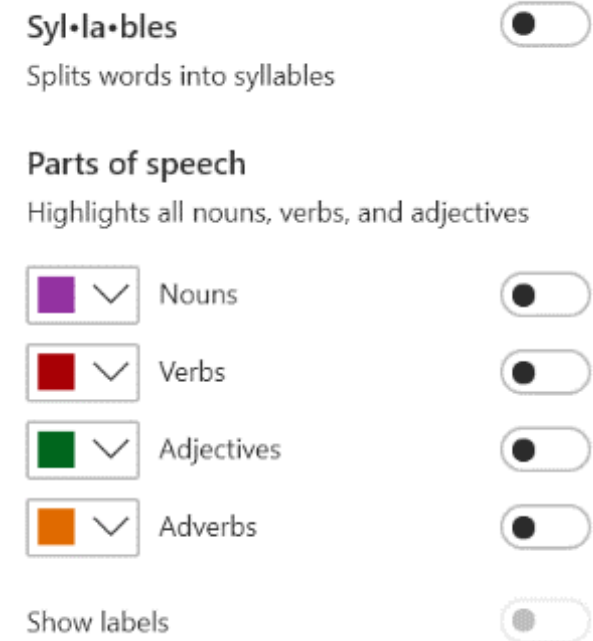

# Microsoft Edge

## Other improvements

### Immersive Reader

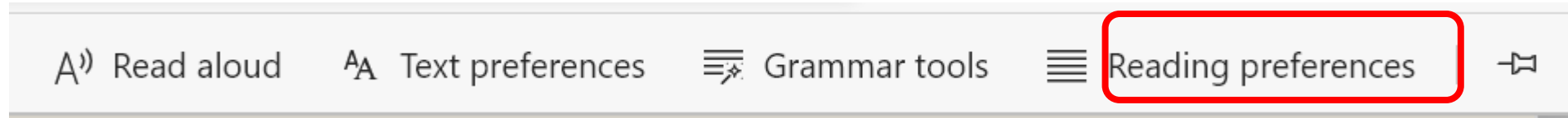

- Line focus helps you focus on one, three, or five lines at a time
- You can translate the page into 50+ languages.

#### Line focus



Helps to focus while reading by highlighting one, three, or five lines



Focus on one line at a time

#### Translate

Choose a language ▼

Translate entire page



# Microsoft Edge

## Other improvements

### How to Use the PDF Viewer

- Make Chromium Edge the default PDF viewer on Windows 10
  - Open **Settings**
  - Click on **Apps**
  - Click on **Default apps**
  - Click the **Set default by app** option
- Double-click the document to open with Edge automatically

.pdf  
PDF Document



Microsoft Edge

# Microsoft Edge

## Other improvements

### Crapware Blocker

- Potentially Unwanted Apps are Crapware aka PUPS (Potentially Unwanted Programs)
- PUPs have been called “malware with a legal team”
- You give permission to install the junk when you click the license agreement, so it’s not technically malware
- Blocking crapware downloads needs to be turned on
- Settings > Privacy and services >
- Under Services, enable the “Block potentially unwanted apps” option

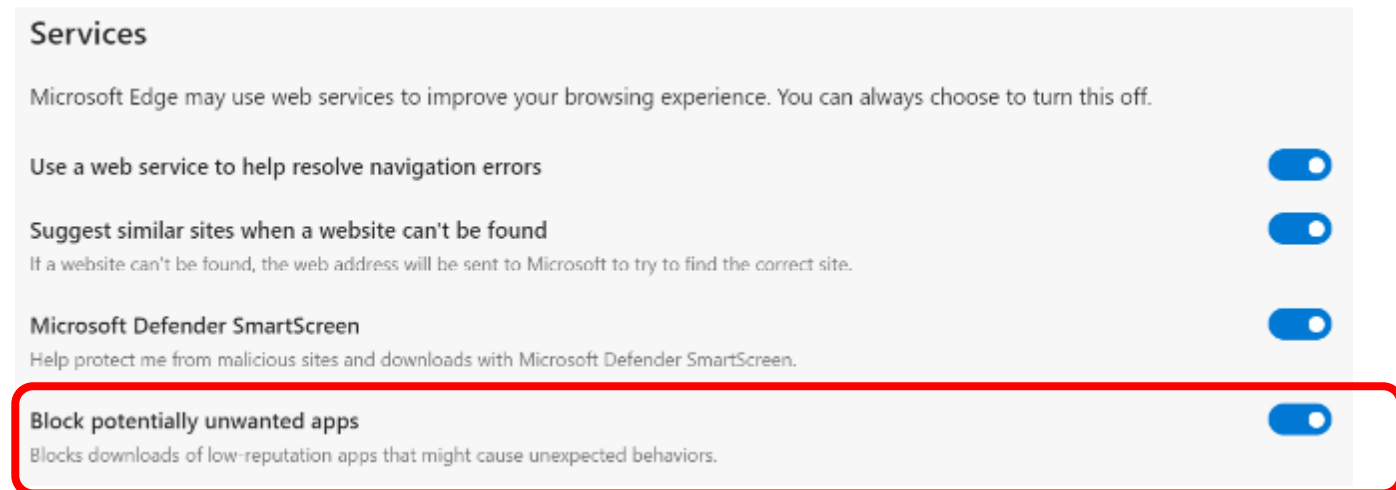
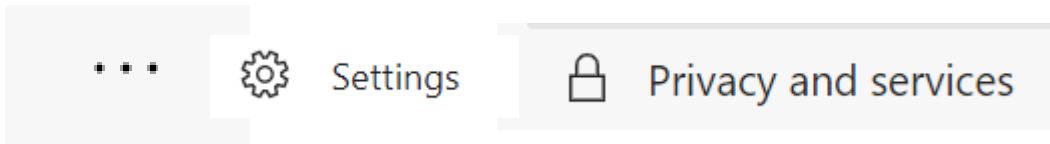



# Microsoft Edge

## Which version of Edge do I have?

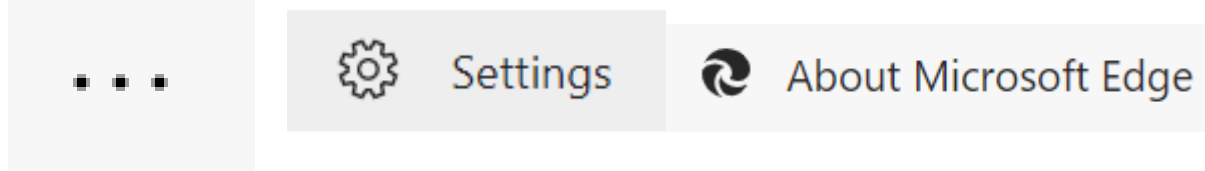

### About



Microsoft Edge



Microsoft Edge is up to date.

Version 84.0.522.49 (Official build) (64-bit)

This browser is made possible by the [Chromium](#) open source project and other [open source software](#).

Microsoft Edge

© 2020 Microsoft Corporation. All rights reserved.

[Terms of use](#) - [Privacy statement](#) - [Microsoft services agreement](#)

# Microsoft Edge

## Deep Dive Into Settings

### The New Edge has two Setting Controls

#### Setting Control for Edge's New Tab Page

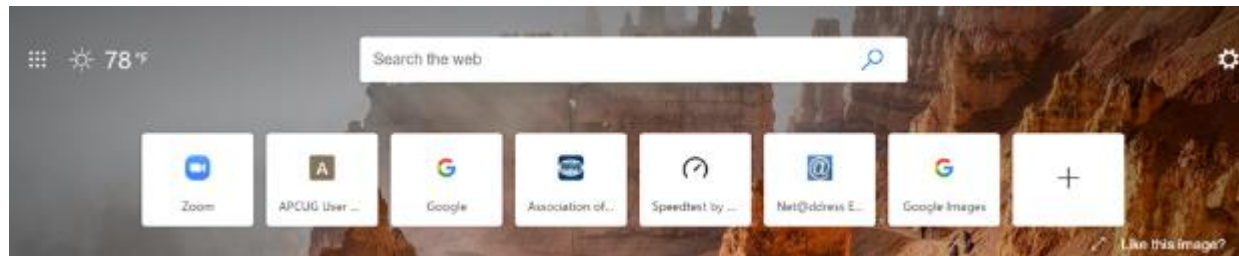

- Here you can customize the New Tab page layout.
- By default, the New Tab page will show a Bing Search bar, quick links to your most visited sites, and some of the top news stories.
- However, there are a few things you can do to customize this page to have a better Edge experience.

# Microsoft Edge

## Deep Dive Into Settings

### Change the New Tab Page Layout

- There are three preset styles to choose from: Focused, Inspirational, and Informational.
- Each one offers a slightly different approach to how you view information on the New Tab page.

**Focused:** The default layout for Edge. A minimalist approach with a Bing search bar, website quick links, and the Microsoft News headings bar.

**Inspirational:** This layout is essentially the same as Focused and looks identical, except it offers the addition of Bing's Image of the Day as the New Tab background.

**Informational:** The last layout has all of the above features, but extends the Microsoft News section even further, offering a more informative approach, showcasing headlines and news articles personalized for you.

# Microsoft Edge

## Deep Dive Into Settings

Fire up Microsoft Edge to get started. If Edge starts where you left off last time, you can get to the New Tab page by clicking on the “+” icon.

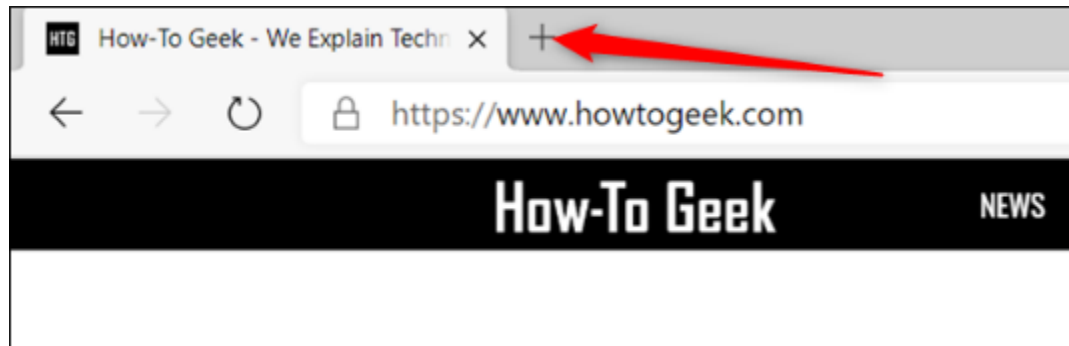

- Click the + sign to open a New Tab page.
- On the New Tab page, click the Settings gear icon in the top-right corner to reveal the page layout schemes available.
- Click the Settings cog to open the page layout selector.
- Test out all the layouts to see which one suits your style.

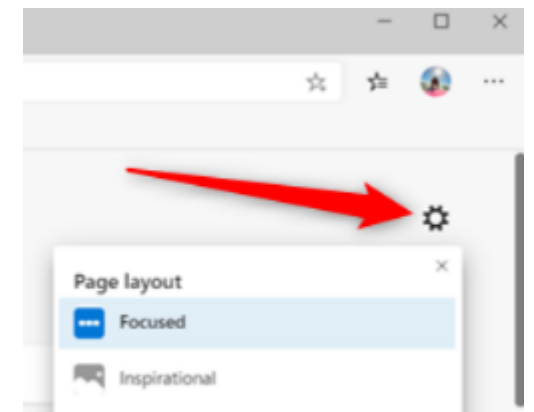

# Microsoft Edge

## Deep Dive Into Settings

### Change the New Tab Page Layout

- You can customize some of the elements on the New Tab page if the preset layouts aren't cutting it for you.
- Click the Settings gear icon and then select "Custom" from the list.
- Click the Settings cog, and then click on "Custom."
- From here, you can enable or disable quick links, image of the day, and manage how you see Microsoft News content.
- The only thing you can't disable is the Bing search bar.

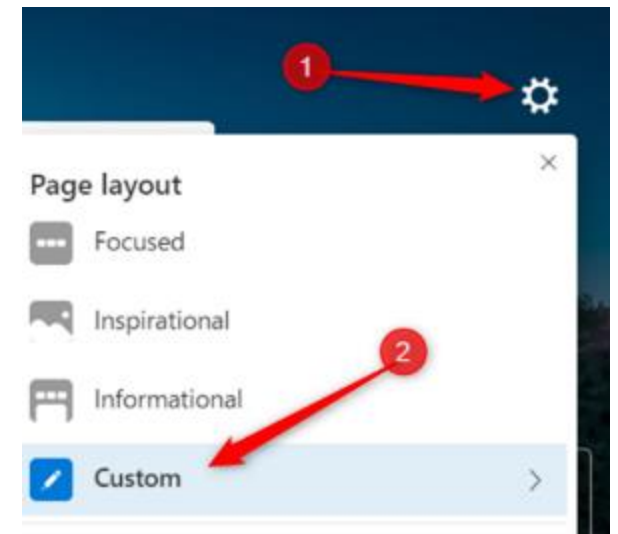

# Microsoft Edge

## Deep Dive Into Settings

- From here, you can enable or disable quick links, image of the day, and manage how you see Microsoft's News content.
- Clicking the dropdown menu under "Content" lets you manage how you view the Microsoft News content that appears at the bottom of the New Tab page.
- You can choose to see the content immediately when the page loads, only the headings, visible on scroll, or not at all.

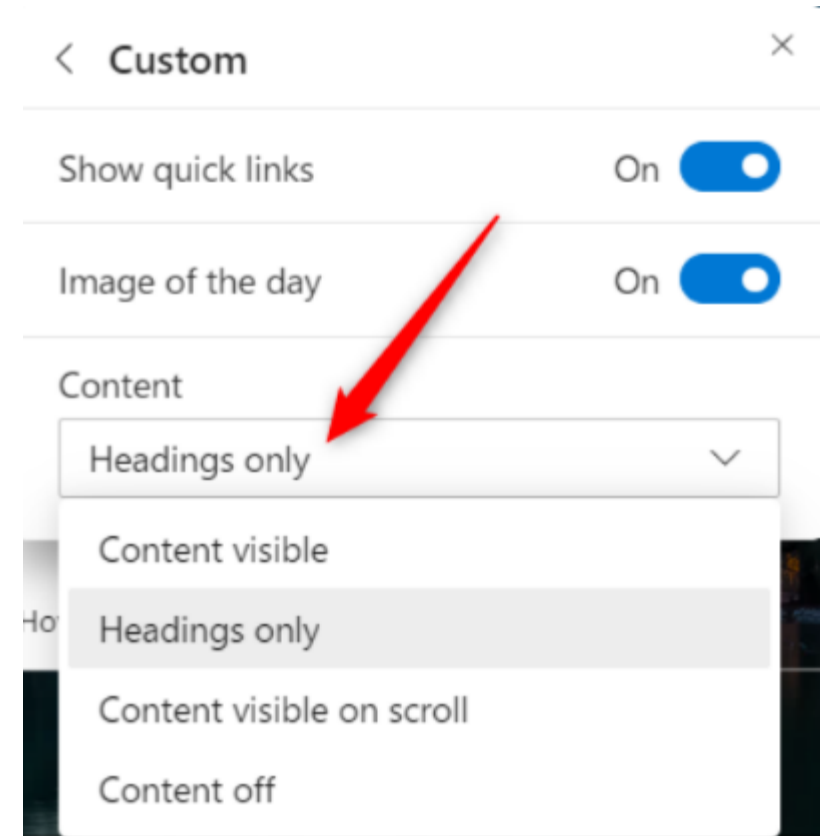

# Microsoft Edge

## Deep Dive Into Settings

### Change the New Tab Page Layout

- If you enjoy the image of the day but don't want all the extra stuff, it's easy to disable the quick links and Microsoft News content.
- This way, all you'll see is a beautiful new image each day when you launch Edge.
- To do this, toggle "Show Quick Links" to the Off position, and then from the dropdown list under "Content," select "Content Off" from the list.
- If you just want to see a nice image each day without any of the tiles or news feed headings, toggle "Show quick links" to the Off position and choose "Content off" from the dropdown menu.
- Otherwise, you can disable everything, giving you a true minimalistic view of the New Tab page.

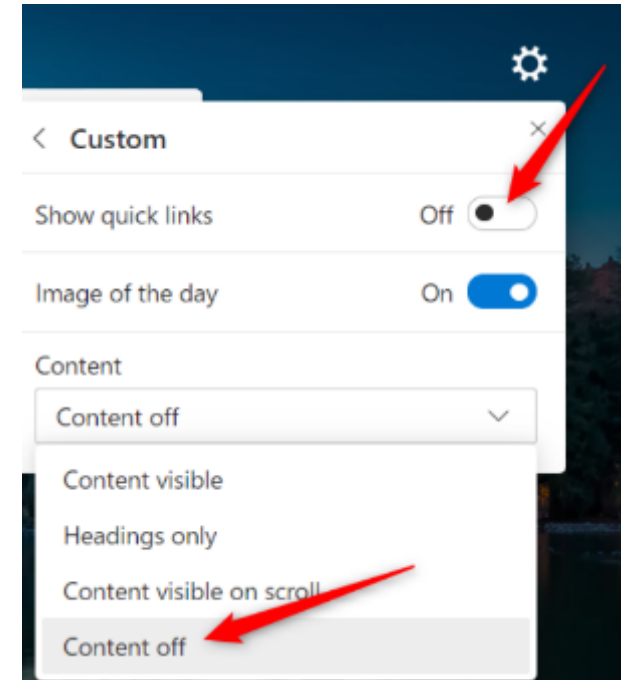

# Microsoft Edge

## Deep Dive Into Settings

### Customize Quick Links

- Edge produces all the Quick Links displayed on the New Tab page from websites you visit, automatically adding them as tiles underneath the search bar.
- You can remove, rename, or add new tiles to the page in a few easy steps.
- To rename a tile, click the three-dot menu icon, and then select “Rename” the list.
- Click the menu icon and click on "Rename" to rename the tile.
- Give the tile a new name and click “Save” when you finish.

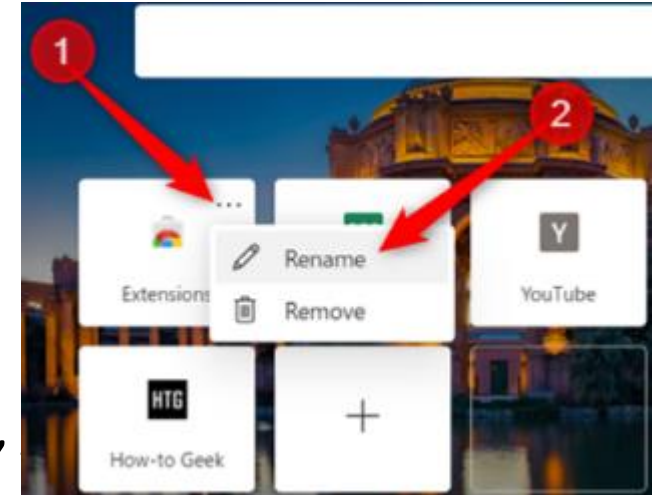



# Microsoft Edge

## Deep Dive Into Settings

### Customize Quick Links

- To add a website to the Quick Links section, click the “+” sign inside the white square.
- In the dialog that opens, enter a name and the URL to the website and then click “Add” to create a new quick link tile.
- Enter a name and the URL to the website, and then click "Add" when you finish.
- To remove a tile, click the three-dot menu icon on the tile you want to delete and select “Remove” from the list.
- To remove a tile from the list, click the menu icon and click "Remove."

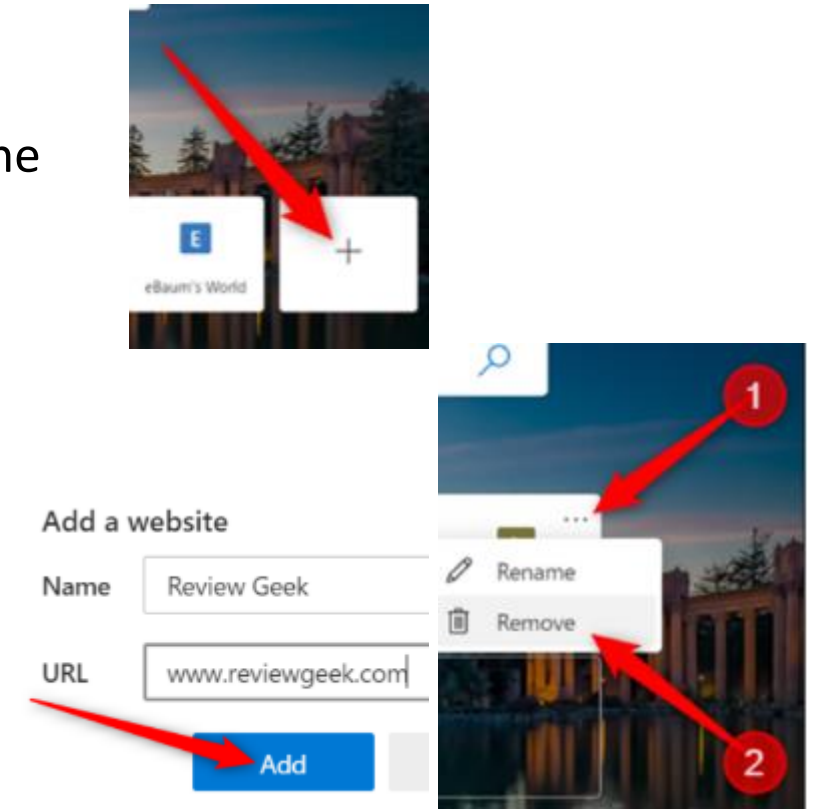

# Microsoft Edge

## Deep Dive Into Settings

### Customize Your Microsoft News Feed

- The news feed at the bottom of the New Tab page—if you haven't disabled it—is personalizable and will show only topics you choose.
- However, to get the most out of it, you will need to specify what your interests are so it can display topics that relate to you.
- From the New Tab page, click “Personalize” in the topic headings of the news feed.
- Click "Personalize" from the news feed headings at the bottom of the page.
- Scroll through the topics and choose the ones that appeal to you by clicking the “+” icon to follow and selecting the green checkmark to unfollow.
- Changes will update instantly and appear automatically after adding or removing from your interest list.

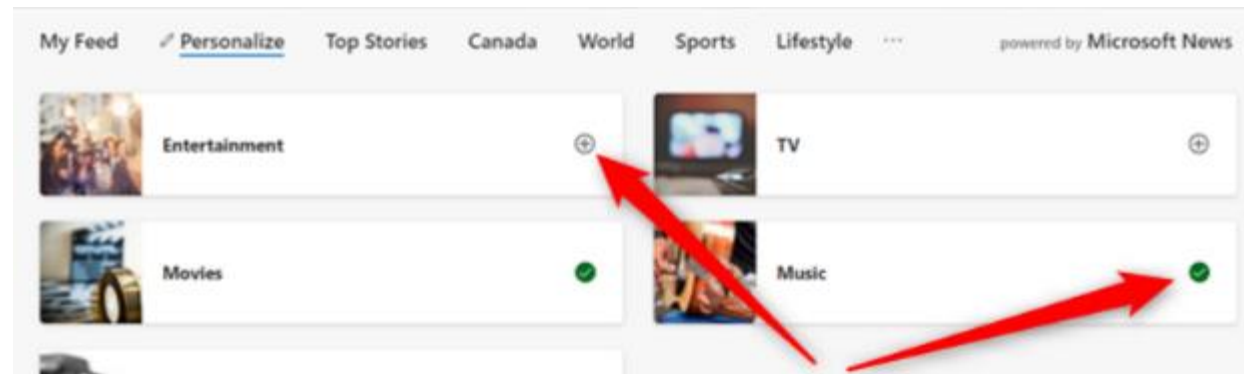
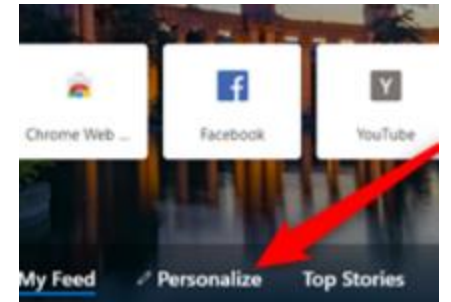

# Microsoft Edge

## Deep Dive Into Settings

### Customize Your Microsoft News Feed

- Scroll to the bottom to toggle the weather information card that appears in the “My Feed” section.
- Weather information cards can be toggled at the bottom of the page.
- After you personalize the news feed to your liking, you can continue browsing the internet or click on any of the headings to see related news stories in your feed.

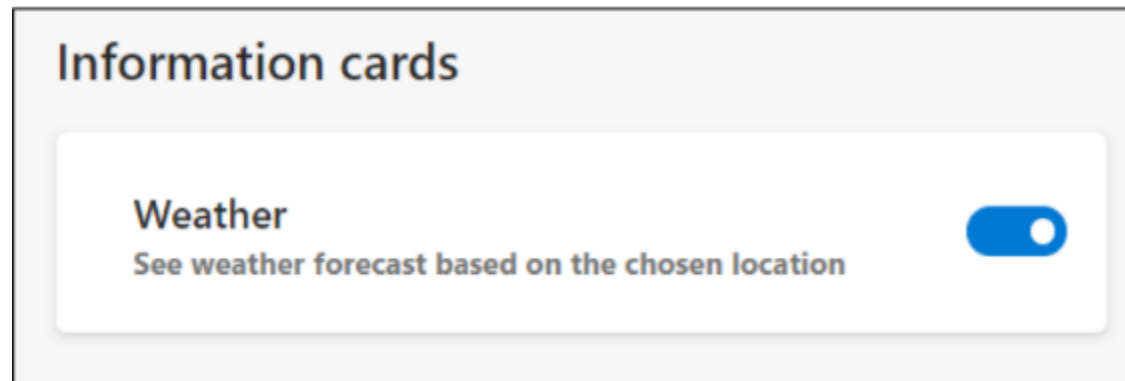

# Microsoft Edge

## Deep Dive Into Settings

- To get into the Edge browser settings, click on the three dots.
- Click on the gear to open the full menu.

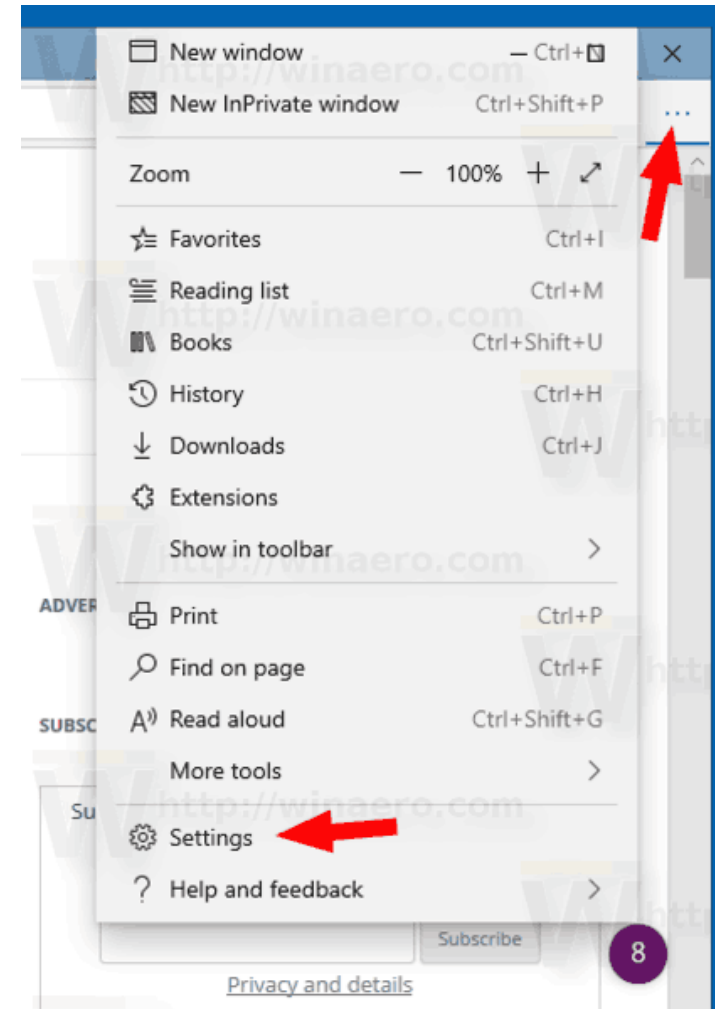















# Microsoft Edge

## Deep Dive Into Settings

- The Settings section of the browser lets you customize your Browser settings to meet your needs.
- Edge now supports a home button and lets you import favorites from another browser, like Chrome.
- You can also Show or Hide the favorites bar, as well as toggle the display of the home button.
- Under its 'Privacy and Services' section, you can configure the browser to:
  - Set Your Profile
  - Set Privacy options
  - Manage Saved passwords
  - Opt to save form entries
  - Choose to block pop-ups and Cookies
  - Manage protected media licenses
  - Send Do Not Track requests
  - Use Page prediction
  - Enable or disable SmartScreen Filter

## ≡ Settings

-  Profiles
-  Privacy and services
-  Appearance
-  On startup
-  New tab page
-  Site permissions
-  Default browser
-  Downloads
-  Family safety
-  Languages
-  Printers
-  System
-  Reset settings
-  Phone and other devices
-  About Microsoft Edge

# Microsoft Edge

## Keyboard Shortcuts

- Most Edge keyboard shortcuts are the same as the Internet Explorer (IE) shortcuts.
- They are both developed by Microsoft, and in a way, the similarity also provides an easier path for users to transition from IE to Edge.
- Though many of the features and functions of Edge can be accessed from the “More actions” and “View advanced settings,” many Windows users may prefer to use keyboard shortcuts.
- Keyboard shortcuts complement the mouse and are a handy way to make web browsing faster.
- Note that as Edge is continuing to evolve, some hotkeys may be added, or may be removed and as the result no longer work.

# Microsoft Edge

## Keyboard Shortcuts

Middle mouse button or CTRL+ Left mouse button: Open link in new background tab

CTRL+ SHIFT+ Left mouse button or CTRL+ SHIFT+ Middle mouse button: Open link in new foreground tab

Middle mouse button on the tab or CTRL+W: Close tab and will close IE window if only one tab is left opened.

CTRL+Q: Open Quick Tab view where a master window will display generated live thumbnail image of all tabbed pages.

CTRL+SHIFT+Q: Instead of thumbnails, view list of all open tabs.

CTRL+T: Open new tab

CTRL+TAB: Switch to next tab

CTRL+SHIFT+TAB: Switch to previous tab

# Microsoft Edge

## Last Stuff

- Browsers are a personal preference.
- It's our door into the world of the Internet.
- Considering that the World Wide Web is such an important part of our lives, using the right browser to service our needs is one of the most important components for using the Internet.
- Aside from the standard fare of Edge, Firefox and Chrome, there are other alternative web browsers that deserve a fair look.
- Some of them are based on pre-existing major browser projects like Chromium, while others strive for a purist "from scratch" approach.
- For the Windows platform, here are five solid alternative choices to the browser scene.

Avast Secure Browser – Brave - Chrome – DuckDuckGo –Opera -- Vivaldi



# Microsoft Edge

## Q and A

- Bill James, APCUG Region 8 Advisor
- Member, APCUG Speakers Bureau
- Contact: [wjames \(at\) apcug.org](mailto:wjames@apcug.org)
- [www.apcug2.org](http://www.apcug2.org)

